



Alfa Laval Access Tank Cover – Oval Cover Type LKD 542 x 446

Tank covers

Introduction

The Alfa Laval Access Tank Cover – Oval Cover Type LKD 542 x 446 is a stainless steel tank cover that provides a secure fit for openings of tanks or containers as well as quick, easy and convenient entry and egress to tank interiors. It is engineered for use on the side of tanks or vessels.

Application

The Access Tank Cover – Oval Cover Type LKD 542 x 446 is mainly designed for use in the beverage, and brewery industries. It is especially suitable for use on tanks or containers that require a closeable means of access to the interior of the vessel. It features an angled, shaped frame to ensure a shadowless installation.

Benefits

- The angled frame design makes the cover more cleanable
- Can withstand up to 2 bar static pressure

Standard design

The construction of the Access Tank Cover – Oval Cover Type LKD 542 x 446 varies, depending on the model. To enable visual inspection and/or physical entry into the tank, the tank cover swings inwards and outwards. The tank cover can be positioned above or below the liquid level to meet different application requirements.

Working principle

Open the cover by loosening the handle. For inspection purposes, the cover can then be turned into the tank. If physical entry into the tank is required, the cover can either be removed at the double hinge or swung out of the tank, depending on the model. Hygienically positioned, the seal is not affected by positive or negative pressure in the tank.

Certificates

3.1 (cover and frame are supplied with material certificate 3.1 according to EN10204)



TECHNICAL DATA

Pressure

Max. static pressure:	2 bar (200 kPa)
Max. positive working pressure:	0 bar (0 kPa)
Max. negative working pressure:	0.5 bar (50 kPa)
Test pressure:	3 bar (300 kPa)

PHYSICAL DATA

Materials

Steel parts:	1.4301 (304) or 1.4404 (316L)
Plastic parts:	Nylon
Seals (FDA): (Lip seal design):	EPDM, NBR, FPM or Q (silicone)

Standard surface finish:

Product wetted surfaces:	Acid Pickled
Other frame and lid surfaces:	Ra 0.8µm
Other support and spindle surfaces:	Ra 3.0µm

Temperature:

EPDM:	-15° / 90° C
NBR:	-30° / 110° C
SILICONE (Q):	-50° / 200° C
FPM:	-10° / 250° C

Weight:	12 kg
---------	-------

Dimensions (mm)

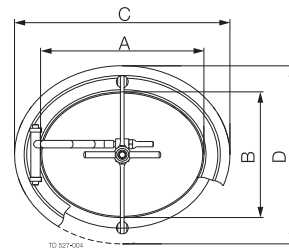
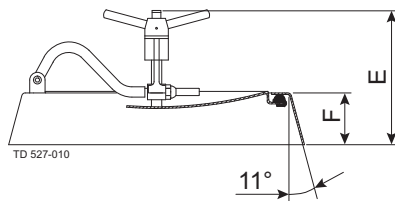

Type	LKD 542 x 446
A	461
B	362
C	542
D	446
E	202
F	76
t	4
Cover thickness	3

Alfa Laval reserves the right to change specifications without prior notification.

How to contact Alfa Laval

Contact details for all countries are continually updated on our website. Please visit www.alfalaval.com to access the information direct.