



Alfa Laval Indication Units for LKB/LKLA - Micro switch

When Indication is all you Need

Concept

The indication units from Alfa Laval are designed as a simple and easy to use, electrical feedback unit for Laval butterfly valves. The units are compatible with all major PLC (Programmable Logic Controller with PNP/NPN interface) and used in food, dairy and brewery installations and in biopharmaceutical applications.

Working principle

A micro switch is a so called sub-miniature switch. It is activated mechanically by a roller leaf. Standard function is normally open (NO), normally closed (NC) and is always a digital signal (on/off).



TECHNICAL DATA

Communication

Interface Digital, NO switch
Supply voltage 24-55 (110) VDC/VAC
Minimum load 100 mA
Maximum load 1 A
Electrical connection M12 plug, (incl counterpart)

"Note! As the unit is not earthed it should not be used for voltage exceeding 55 V"



PHYSICAL DATA

Materials

Steel parts Stainless steel and Brass
Plastic parts PA6 and PPO/PS
Seals Nitrile (NBR) rubber
Contact pins Gold-plated

Environment

Working temperature -25°C to +80°C
Protection rating IP 67

Cable connection

Counterpart M12 socket
Termination Screw
Max wire size 0.129 mm² (AWG26)
Cable gland entry PG7 (3 - 6.5 mm)

Note!

Compatible brackets are available for the actuators and handles for LKB butterfly valves.

For further information: See also ESE001257.

Options

- Valve compatibility

Accessories

- Various cable options

Compatible actuators

LKLA \varnothing 85	Yes
LKLA \varnothing 133	Yes

Compatible Valves

LKB	Yes
LKB-2	Yes

Electrical connection

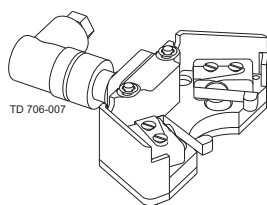

- 3. \varnothing 3 closed valve
- 2. \varnothing 2 open valve

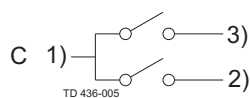

Alfa Laval reserves the right to change specifications without prior notification.

How to contact Alfa Laval

Contact details for all countries are continually updated on our website. Please visit www.alfalaval.com to access the information direct.